

WILLEM BURGER COMPLEX FOURTH FLOOR

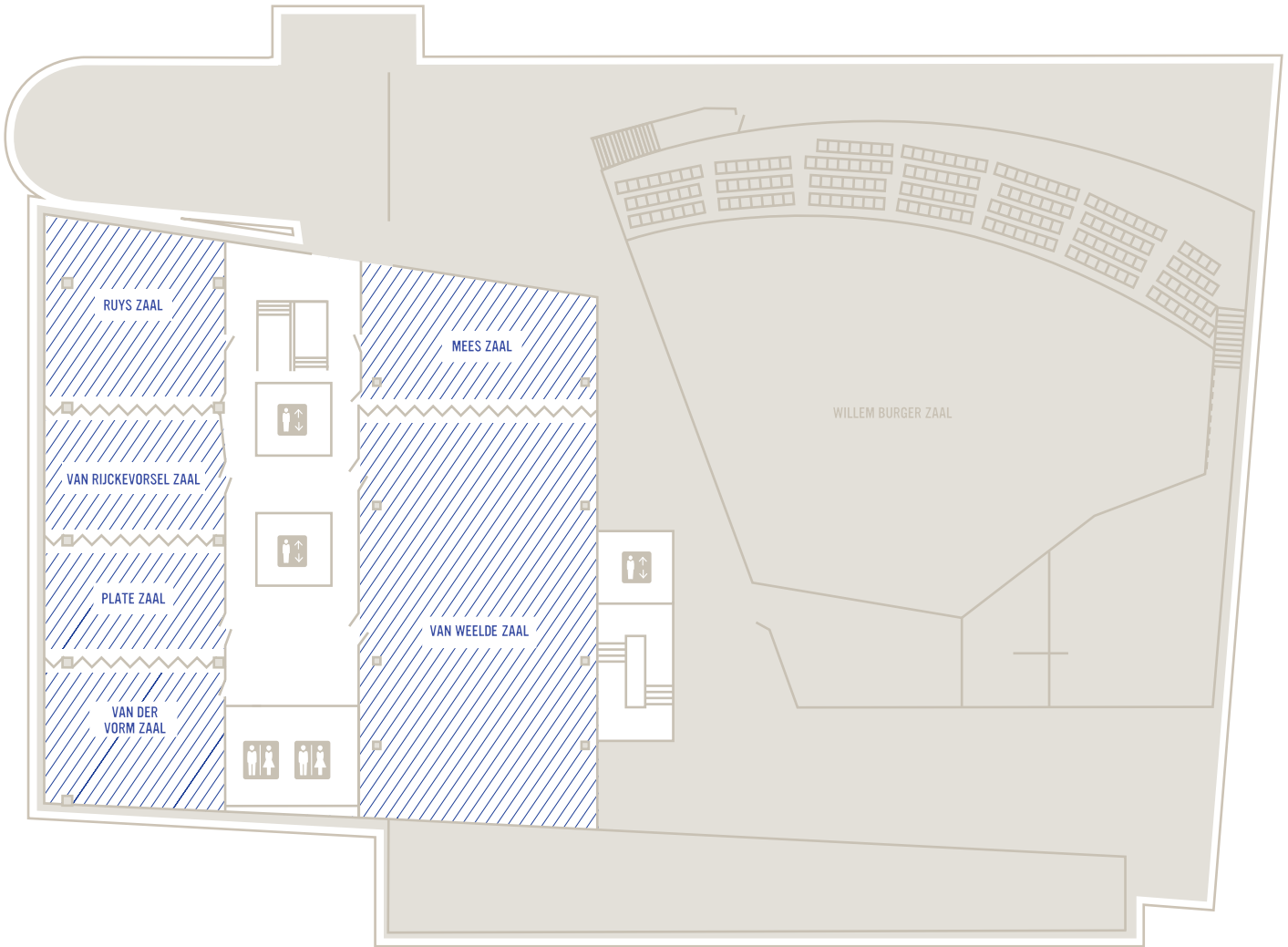

LEGEND



VAN WEELDE ZAAL

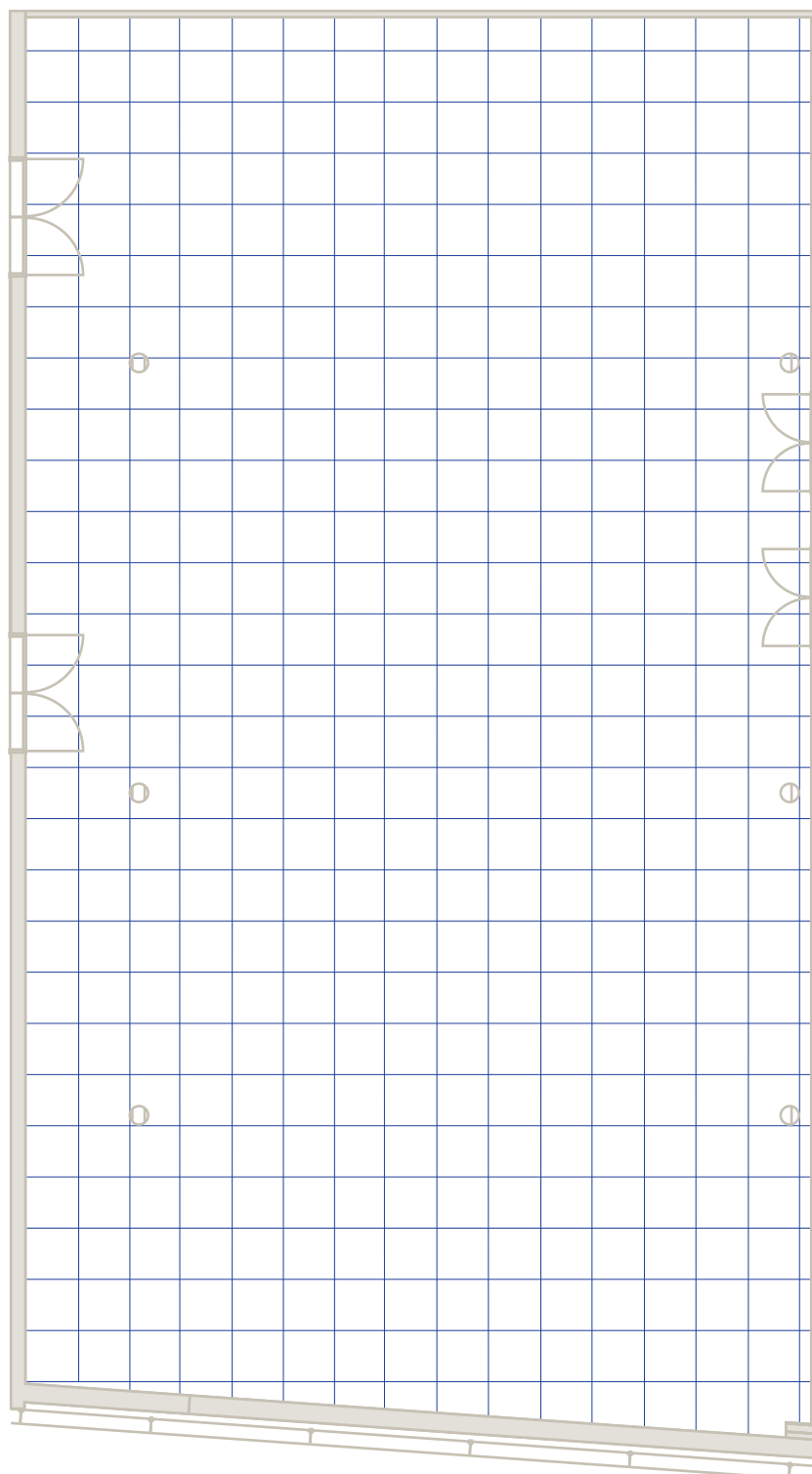

VAN RIJCKEVORSEL ZAAL

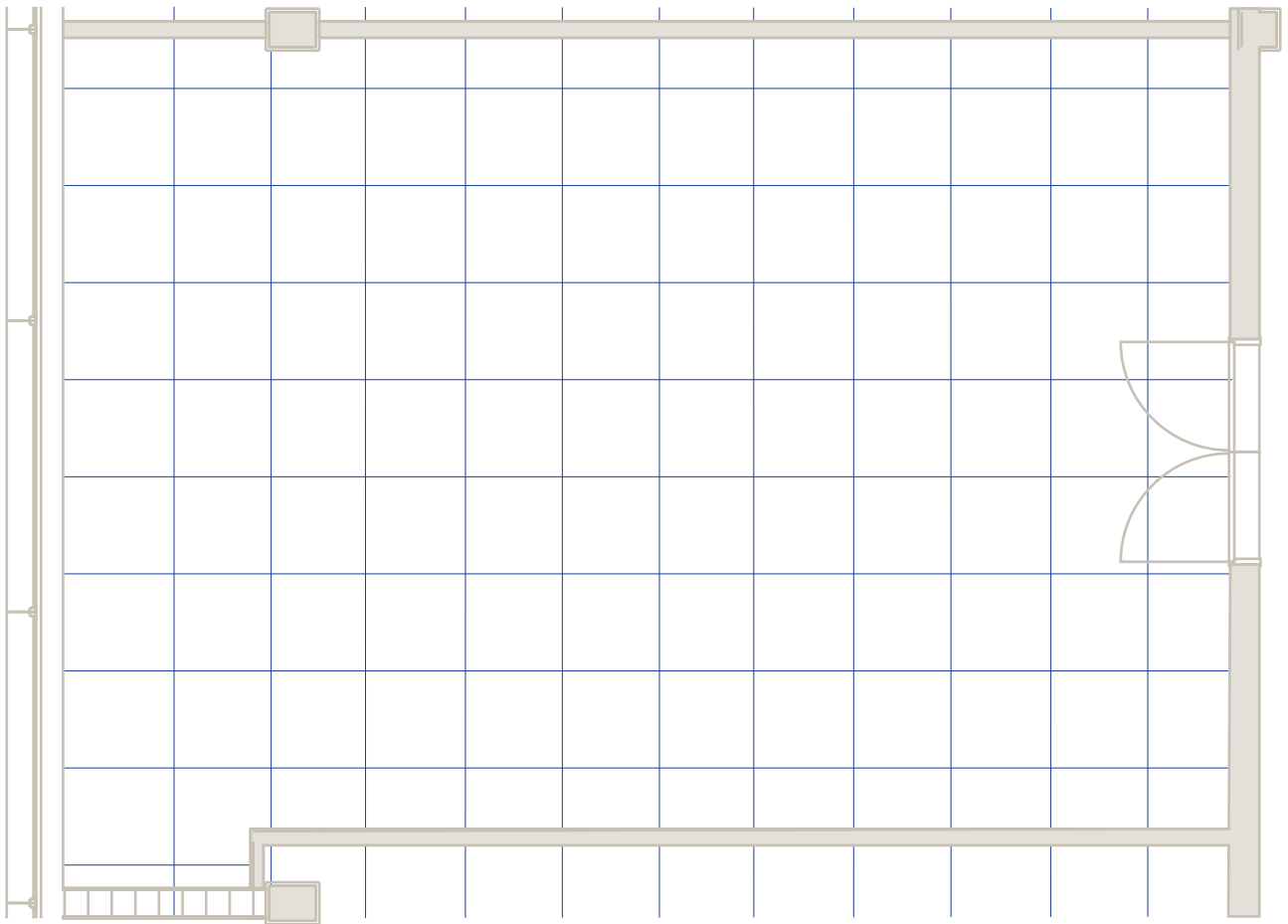

 2X2^m

VAN DER VORM ZAAL

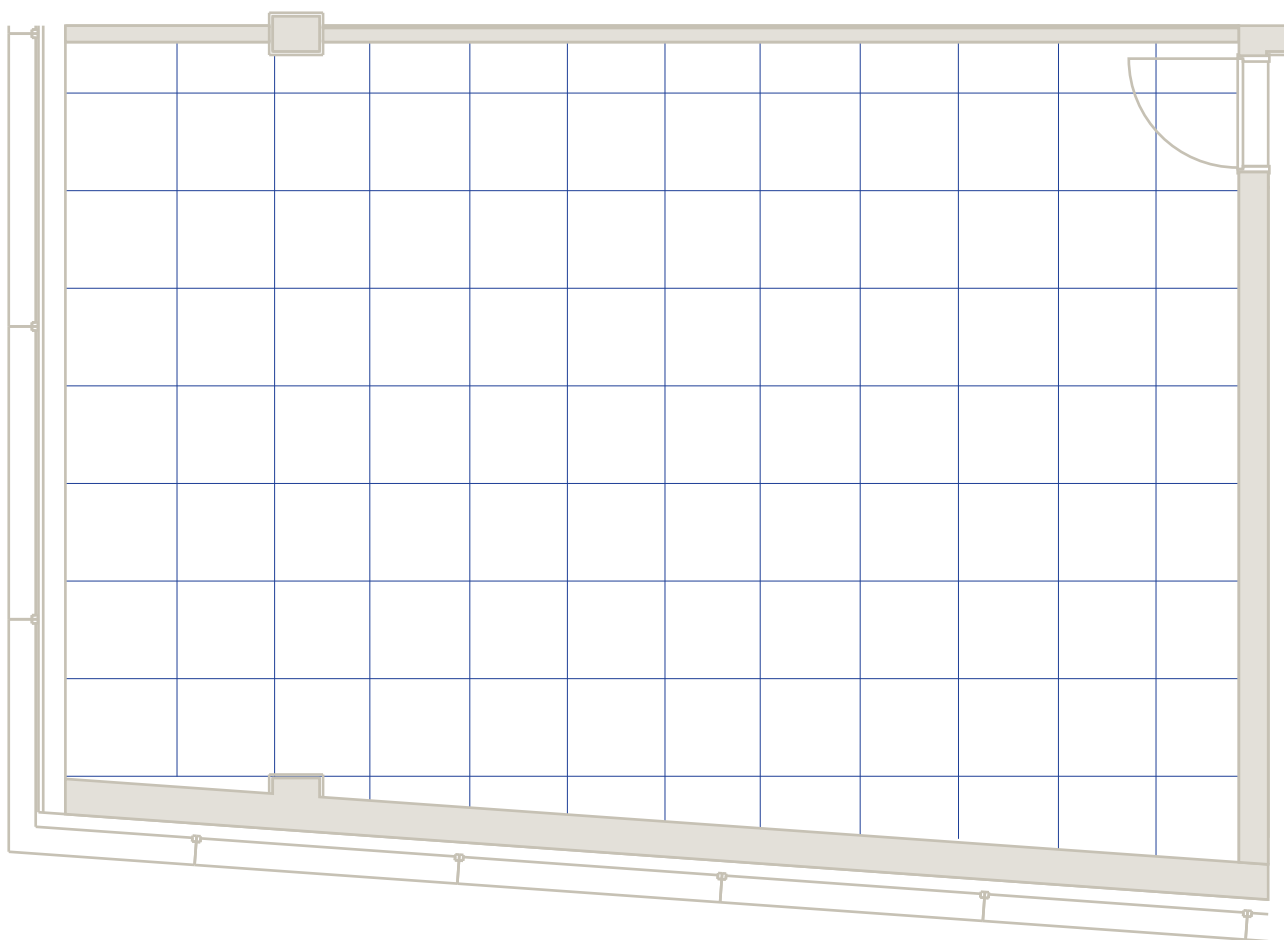

 2X2^m

RUYS ZAAL

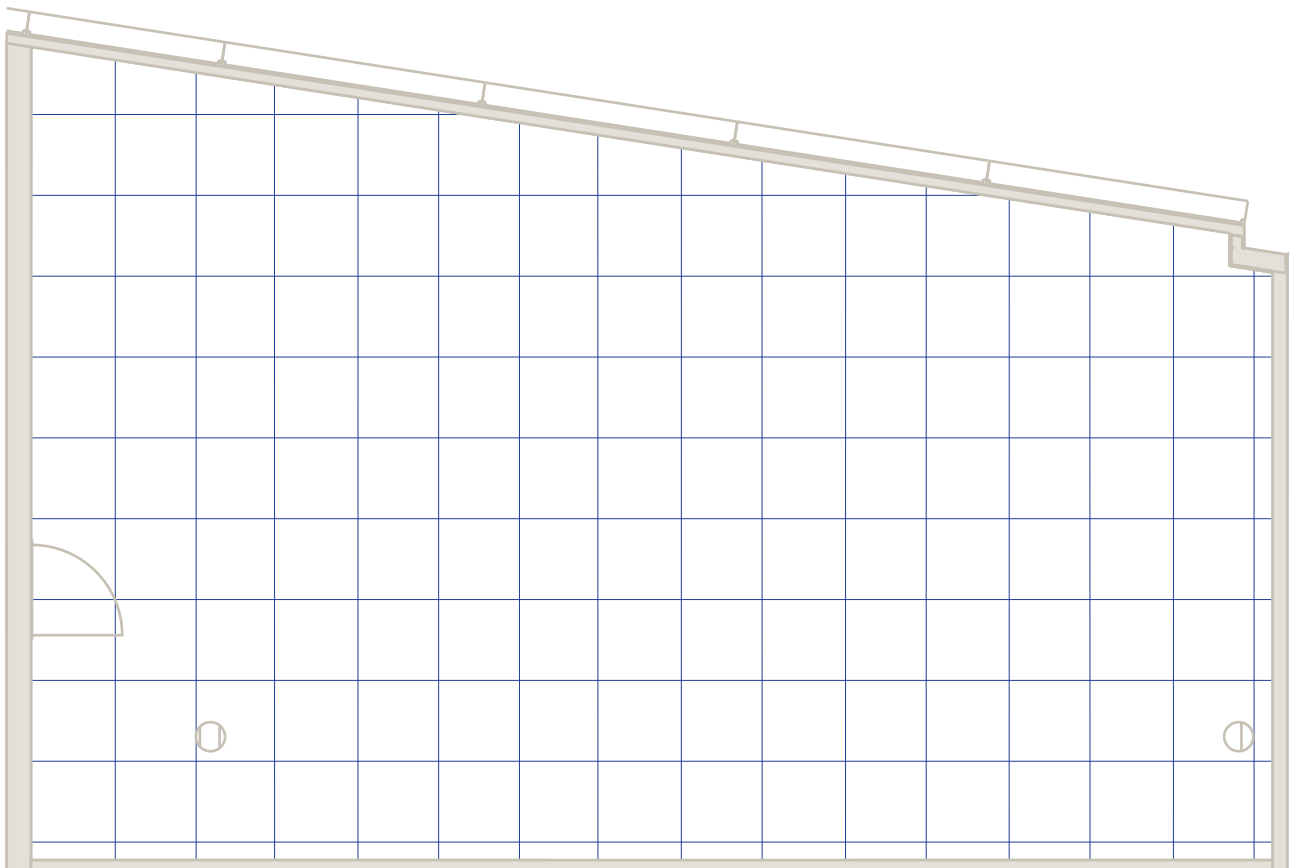
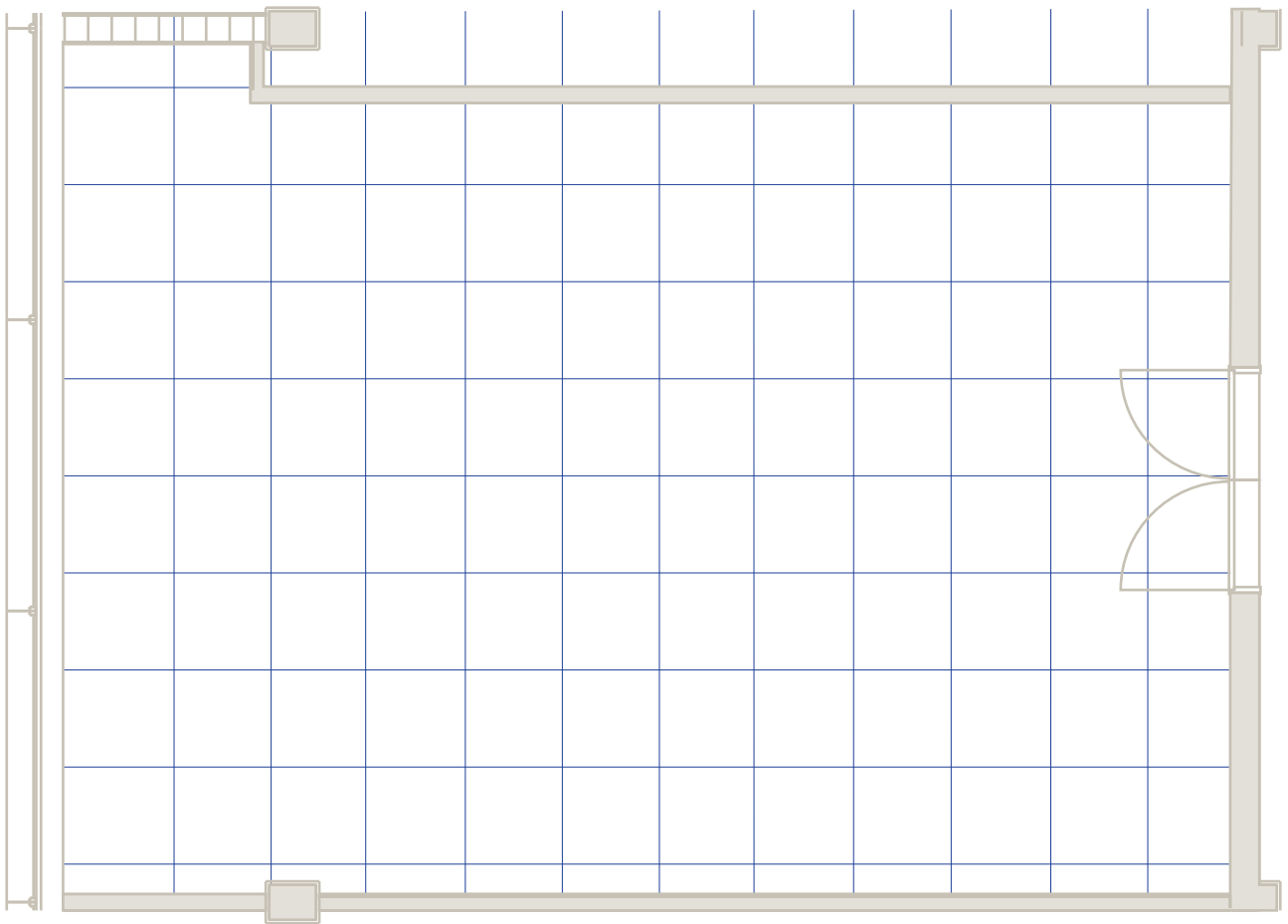
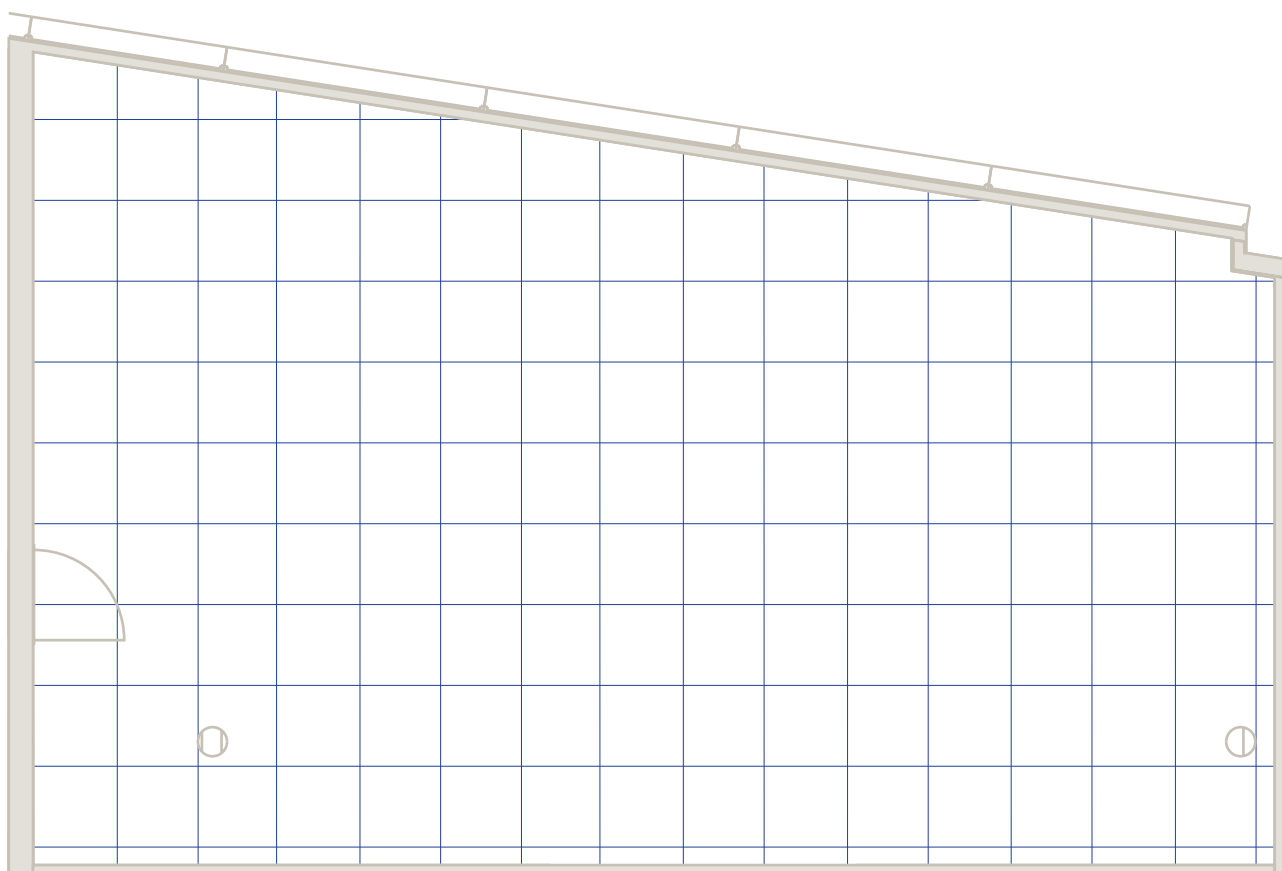

PLATE ZAAL











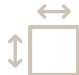

 2X2^M

MEES ZAAL



CAPACITY TABLE

	 MEASUREMENT	 L X W	 HEIGHT	 CABARET	 U-SHAPE	 CLASSROOM	 THEATRE	 DINNER	 RECEPTION	 AIRCO	 DAYLIGHT
Grote Zaal	2400 m ²	-	19 m	-	-	-	1755	-	-	yes	no
Port of Rotterdam Foyer	1400 m ²	-	7 m	-	-	-	-	1000	1500	yes	yes
Hal Grote Zaal	2320 m ²	-	2,5-5 m	-	-	-	-	900	1200	yes	yes
Verhagen Dakfoyer	84 m ²	12 x 7 m	3 m	36	24	24	60	40	60	yes	yes
Jurriaanse Zaal	532 m ²	-	11 m	-	-	-	465	-	-	yes	no
Jurriaanse Foyer	700 m ²	-	7 m	-	-	-	-	400	600	yes	yes
Jurriaanse Hall	690 m ²	-	2,94 m	-	-	-	-	100	200	yes	yes
Van Cappellen Zaal	150 m ²	-	3,5 m	-	-	-	142	-	-	no	no
Arcadis Zaal	456 m ²	38 x 12 m	7 m	270	100	180	450	370	500	yes	yes
Van der Mandele Zaal	209 m ²	11 x 19 m	7 m	60	30	45	150	100	150	yes	yes
Eduard Flipse Zaal	216 m ²	12 x 18 m	7 m	120	58	108	150	100		yes	yes
De Monchy Zaal	91 m ²	7 x 13 m	2,8 m	40	26	26	85	50	100	yes	no
De Leeuw Kamer*	28 m ²	5 x 5 m	2,8 m	12	16	-	24	-	-	yes	yes
Keuris Kamer*	23 m ²	5 x 4 m	2,8 m	8	10	-	18	-	-	yes	yes
Schat Kamer*	28 m ²	5 x 5 m	2,8 m	12	12	-	20	-	-	yes	yes

* These conference rooms have flexible dividing walls

CAPACITY TABLE

CONGRESS CENTRE	MEASUREMENT	L X W	HEIGHT	CABARET	U-SHAPE	CLASSROOM	THEATRE	DINNER	RECEPTION	AIRCO	DAYLIGHT
Willem Burger Zaal	710 m ²	-	7,50 m	-	-	-	700	-	-	yes	yes
Willem Burger Foyer	540 m ²	-	3,30-9,30	-	-	-	-	350	700	yes	yes
Willem Burger Hall	680 m ²	36 x 19 m	8,20 m	-	-	-	-	370	700	yes	yes
Zeelenberg Zaal	98 m ²	7 x 14 m	2,70 m	48	38	56	90	-	-	yes	yes
Hudig Zaal	80 m ²	9 x 9 m	3,60 m	24	26	32	66	39	70	yes	yes
Schadee Zaal	90 m ²	9 x 10 m	3,60 m	24	30	32	66	50	100	yes	yes
Van Beuningen Zaal	115 m ²	9 x 13 m	3,60 m	32	30	40	87	60	120	yes	yes
Ruys Zaal*	100 m ²	10 x 10 m	4,75 m	32	26	40	66	45	-	yes	yes
Van Rijckevorsel Zaal*	60 m ²	10 x 6 m	4,75 m	20	20	20	45	30	-	yes	yes
Plate Zaal*	60 m ²	10 x 6 m	4,75 m	20	20	20	45	30	-	yes	yes
Van der Vom Zaal*	70 m ²	10 x 7 m	4,75 m	20	20	20	47	25	-	yes	yes
Mees Zaal*	90 m ²	13 x 7 m	4,75 m	20	20	24	64	-	-	yes	yes
Van Weelde Zaal*	300 m ²	13 x 23 m	4,75 m	84	58	132	242	150	300	yes	yes

* These conference rooms have flexible dividing walls